

Superintendent's Report to the Community

West Branch Community School District, summer, 2017



Vision: A Future Focused Community of Learners
Mission: Preparing Students to Live and Learn with Passion and Purpose
Destination: All Students are Career and College Ready

W.B.C.S.D. TEACHING and LEARNING PLAYBOOK (Strategic Intent)

**As developed and monitored through the ongoing efforts of the District's School Improvement Advisory Committees (S.I.A.C.), the West Branch Board of Education, community, staff, parents, students and administrators.*

Goal #1: Enhance and Promote Effective Teaching and Learning Practices: Implement evidence-based and student-centered teaching and learning practices designed to improve the academic performance and success of all students. I. Leveraging Instructional Leadership:

1. Focus on high impact teaching strategies:
 - a. agreed upon *non-negotiable components in effective lesson design and delivery*
 - b. *use of data to inform teaching and collaborative teaming* focused on improving student outcomes
 - c. *effective use of technologies* to support deeper student learning and research-skills
 - d. *personalized, interest-based teaching and learning* strategies and opportunities
 - e. *effective school leadership teams with common formats and monitoring*
2. All teachers receive routine, one-on-one collaborative conversations with building principals
3. All teachers receive routine instructional support from the district's instructional coaches
4. Differentiated professional development for all staff
5. PK-12 common grading and feedback processes for students and parent
6. Promotion of post-secondary, workforce learning and training opportunities

Goal #2: Invest in Human Capital and Leadership

1. Implementation of common hiring protocols
2. Implementation of differentiated staff professional development and training
3. Scaling leadership across the organization
4. Providing competitive salaries and benefits that attracts and retain teaching and leadership talent

Goal #3: (A) Enhance and Maintain Facilities (B) Develop and Implement Short and Long-Term Facilities Improvements Plans

1. Development and Implement of a "15-Year Master Facility Improvement Plan" as a guide for Board, administrative and community decision-making
2. Prepare for and implement Board directed bond-referendum related facilities improvements
3. Effective use of Physical Plant and Educational Levy (PEL) and School Infrastructure Levy Fund (SAVE) for ongoing facility improvements and maintenance.

Goal #4: Meet District Financial Goals and Priorities (see trend data provide in this document)

Goal #5: Improve Social-Emotional Learning for Students and Organizational Culture for Staff

II. Leveraging Culture-Building Leadership:

1. Practices that create *bully-free, friendly, emotionally supportive* learning environments
2. Fostering a *positive, results-oriented work culture* for all staff
3. Promotion of and *support for mental and physical wellness* for students and staff
4. Promotion of *multi-activity, extra-curricular participation* by all students

Goal #6: Expand Community, Business, Civic and Regional Education Partnerships

Key Finance Information

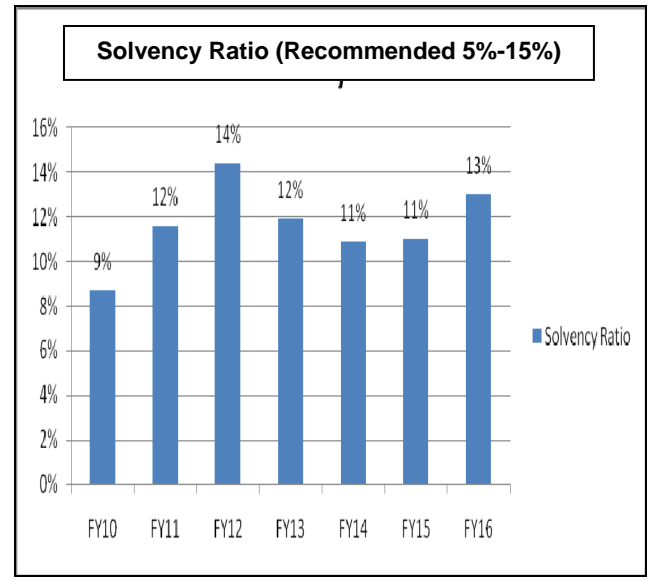
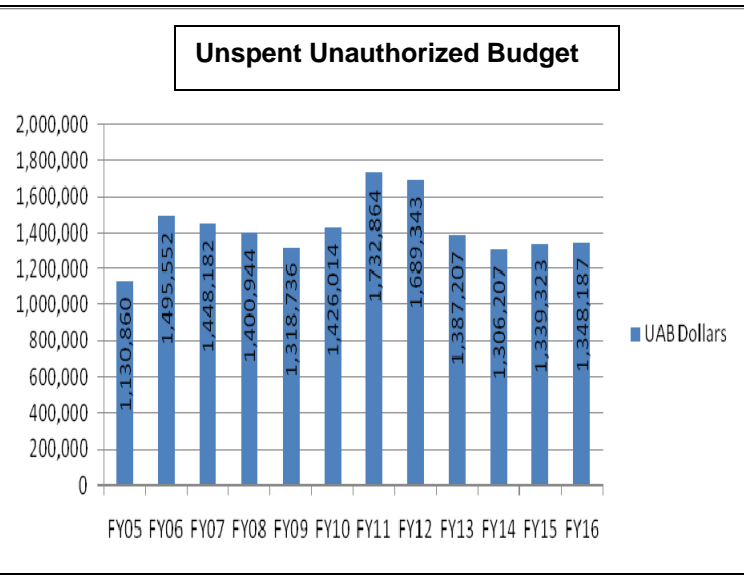
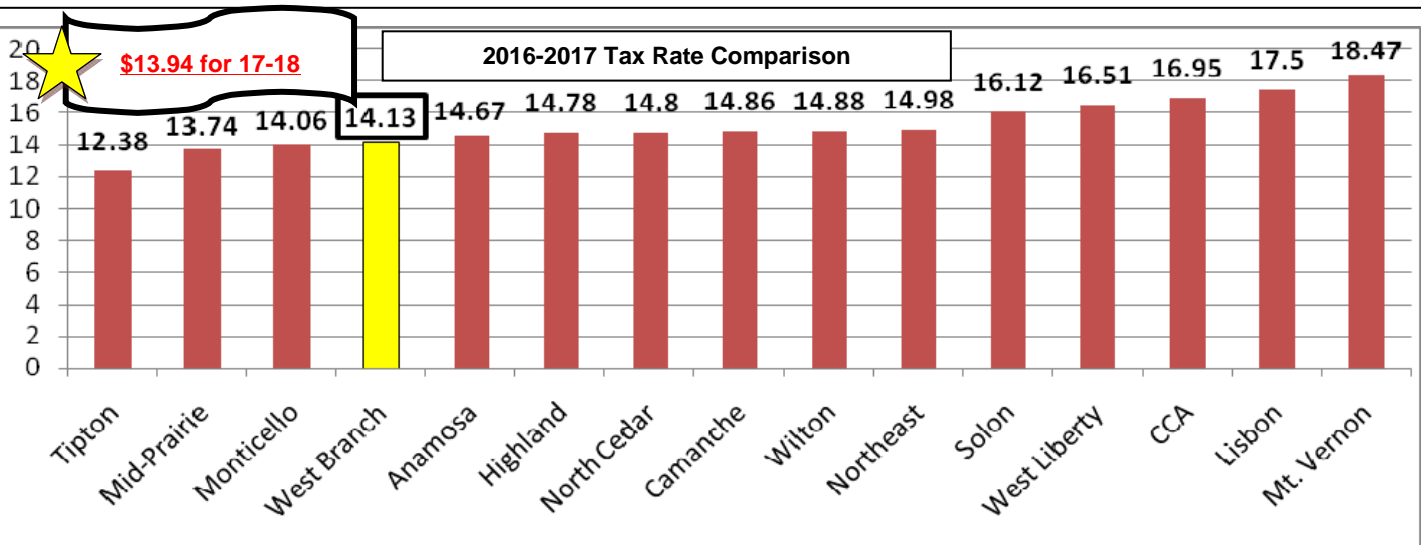
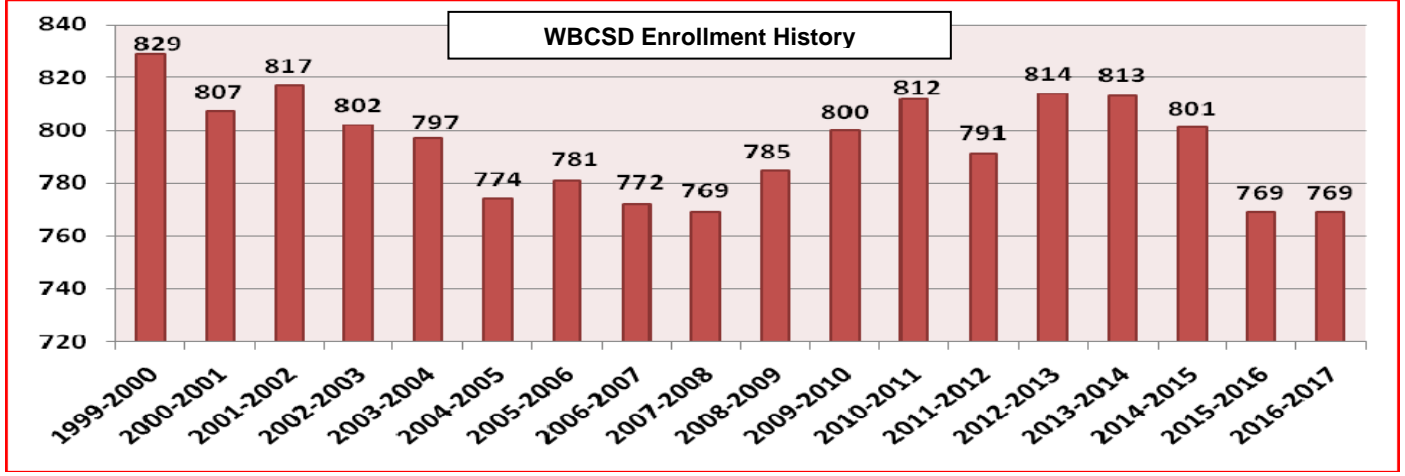

WBCSD 10-Year Utilities Summary

School Year	Gas		Electric		H2O		Total
	Cost	Units	Cost	Units	Cost	Units	Total Cost
2016-2017	\$ 17,773.74	24,515	\$ 179,146.28	1,664,342	\$ 25,690.79	3,050,900	\$ 222,610.81
2015-2016	\$ 26,664.26	40,180	\$ 178,342.29	1,763,033	\$ 32,285.06	3,734,000	\$ 237,291.61
2014-2015	\$ 35,615.34	47,580	\$ 176,649.97	1,701,192	\$ 26,390.71	3,550,500	\$ 238,656.02
2013-2014	\$ 40,400.53	56,495	\$ 184,056.04	1,776,683	\$ 23,451.60	3,829,200	\$ 247,908.17
2012-2013	\$ 31,519.25	46,680	\$ 158,814.40	1,551,138	\$ 21,201.33	4,140,600	\$ 211,534.98
2011-2012	\$ 33,355.76	46,050	\$ 141,921.74	1,546,669	\$ 22,488.00	4,769,150	\$ 197,765.50
2010-2011	\$ 43,722.25	53,812	\$ 153,158.96	1,459,197	\$ 16,029.20	2,809,000	\$ 212,910.41
2009-2010	\$ 46,858.59	50,307	\$ 154,031.91	1,572,715	\$ 13,561.31	1,986,566	\$ 214,451.81
2008-2009	\$ 75,555.41	73,837	\$ 84,478.42	773,796	\$ 15,984.93	1,906,554	\$ 176,018.76
2007-2008	\$ 69,278.93	64,232	\$ 91,088.49	926,820	\$ 11,346.23	1,391,610	\$ 171,713.65
School Year	Gas		Electric		H2O		Total
	Cost	Units	Cost	Units	Cost	Units	Total Cost
Elem 16-17	\$ 3,289.62	3,818	\$ 84,449.24	845,516	\$ 9,450.99	1,006,000	\$ 97,189.85
Elem 15-16	\$ 2,624.09	2,471	\$ 84,161.81	881,969	\$ 17,496.25	1,984,000	\$ 104,282.15
Elem 14-15	\$ 2,668.37	2,070	\$ 82,523.18	819,987	\$ 10,749.04	1,298,000	\$ 95,940.59
Elem 13-14	\$ 2,856.60	2,251	\$ 87,727.46	869,891	\$ 6,893.10	1,144,000	\$ 97,477.16
Elem 12-13	\$ 1,422.41	526	\$ 74,917.83	721,201	\$ 6,980.61	1,350,000	\$ 83,320.85
Elem 11-12	\$ 1,159.13	164	\$ 66,999.75	709,836	\$ 6,228.41	1,355,300	\$ 74,387.29
Elem 10-11	\$ 1,192.80	214	\$ 73,321.12	746,394	\$ 4,596.42	998,000	\$ 79,110.34
Elem 09-10	\$ 2,668.26	902	\$ 79,705.67	808,623	\$ 5,340.70	891,566	\$ 87,714.63
Elem 08-09	\$ 31,774.72	29,279	\$ 26,188.17	275,974	\$ 6,665.22	860,954	\$ 64,628.11
Elem 07-08	\$ 27,471.73	22,954	\$ 27,459.47	285,472	\$ 5,916.65	753,010	\$ 60,847.85
School Year	Gas		Electric		H2O		Total
	Cost	Units	Cost	Units	Cost	Units	Total Cost
MS 16-17	\$ 8,049.70	12,091	\$ 20,066.33	146,880	\$ 4,092.63	528,000	\$ 32,208.66
MS 15-16	\$ 6,170.19	10,468	\$ 18,920.99	155,423	\$ 2,142.44	296,000	\$ 27,233.62
MS 14-15	\$ 9,804.54	12,040	\$ 18,221.15	158,524	\$ 2,116.18	308,000	\$ 30,141.87
MS 13-14	\$ 12,177.83	12,326	\$ 19,264.66	163,324	\$ 2,100.46	352,000	\$ 33,542.95
MS 12-13	\$ 9,181.31	12,028	\$ 15,717.58	142,124	\$ 1,524.82	294,000	\$ 26,423.71
MS 11-12	\$ 7,541.49	10,135	\$ 13,401.61	127,324	\$ 1,117.20	242,000	\$ 22,060.30
MS 10-11	\$ 10,857.44	13530	\$ 15,357.01	138,127	\$ 639.84	138,000	\$ 26,854.29
MS 09-10	\$ 12,877.60	13,694	\$ 15,475.69	148,124	\$ 815.04	137,000	\$ 29,168.33
MS 08-09	\$ 13,875.57	12,568	\$ 10,021.11	104,847	\$ 857.07	104,000	\$ 24,753.75
MS 07-08	\$ 11,371.44	9,477	\$ 10,668.56	115,884	\$ 1,002.89	121,000	\$ 23,042.89
School Year	Gas		Electric		H2O		Total
	Cost	Units	Cost	Units	Cost	Units	Total Cost
HS 16-17	\$ 4,036.69	5,914	\$ 67,767.68	632,578	\$ 10,719.04	1,376,000	\$ 82,523.41
HS 15-16	\$ 15,570.45	25,353	\$ 68,053.03	682,320	\$ 11,736.68	1,404,000	\$ 95,360.16
HS 14-15	\$ 20,657.52	25,082	\$ 67,888.17	667,973	\$ 11,732.74	1,719,000	\$ 100,278.43
HS 13-14	\$ 21,517.88	30,744	\$ 69,498.86	689,325	\$ 12,861.60	2,102,000	\$ 103,878.34
HS 12-13	\$ 16,824.51	25,887	\$ 60,787.20	631,310	\$ 10,413.81	2,086,000	\$ 88,025.52
HS 11-12	\$ 21,437.56	31,990	\$ 53,902.31	647,371	\$ 13,375.26	2,842,000	\$ 88,715.13
HS 10-11	\$ 25,896.44	34,571	\$ 46,133.28	517,474	\$ 7,564.32	1,648,000	\$ 79,594.04
HS 09-10	\$ 24,209.89	31,418	\$ 51,143.41	548,221	\$ 5,378.58	938,000	\$ 80,731.88
HS 08-09	\$ 26,096.78	28,803	\$ 36,292.42	391,419	\$ 7,763.79	940,600	\$ 70,152.99
HS 07-08	\$ 29,027.25	28,703	\$ 47,981.58	524,553	\$ 4,067.33	493,600	\$ 81,076.16
School Year	Gas		Electric		H2O		Total
	Cost	Units	Cost	Units	Cost	Units	Total Cost
Misc 16-17	\$ 2,397.73	2,692	\$ 6,863.03	39,368	\$ 1,428.13	140,900	\$ 10,688.89
Misc 15-16	\$ 2,299.53	1,888	\$ 7,206.46	43,321	\$ 909.69	50,000	\$ 10,415.68
Misc 14-15	\$ 2,484.91	8,388	\$ 8,017.47	54,708	\$ 1,792.75	225,500	\$ 12,295.13
Misc 13-14	\$ 4,097.63	11,174	\$ 7,565.06	54,143	\$ 1,596.44	231,200	\$ 13,259.13
Misc 12-13	\$ 4,338.93	8,239	\$ 7,391.79	56,503	\$ 2,282.09	410,600	\$ 14,012.81
Misc 11-12	\$ 3,715.29	3,761	\$ 7,618.07	62,138	\$ 1,767.15	329,850	\$ 13,100.51
Misc 10-11	\$ 5,522.06	5,497	\$ 7,254.81	57,202	\$ 396.45	25,000	\$ 13,173.32
Misc 09-10	\$ 4,202.52	4,293	\$ 7,707.14	67747	\$ 318.80	20000	\$ 12,228.46
Misc 08-09	\$ 3,706.34	3,187	\$ 5,519.46	1556	\$ 450.80	1000	\$ 9,676.60
Misc 07-08	\$ 3,936.52	3,098	\$ 4,978.88	911	\$ 359.36	24000	\$ 9,274.76

Student Achievement in the West Branch Community Schools

W.B.C.S.D. Core Values and Beliefs

1. We believe our students need global, project-based, technology enriched, personalized learning experiences.
2. We believe our students deserve effective, rigorous, facilitative teaching and leadership opportunities.
3. We believe our students and staff deserve safe, world-class learning facilities to enhance our chances of living out the District's Vision, Mission and Destination goals.
4. We believe in safe, healthy, non-threatening learning environments where all students and staff feel connected, cared for and supported. (Adopted, 2014, SIAC)

Math Proficiencies		2013-2014	2014-2015	2015-2016	Reading Proficiencies		2013-2014	2014-2015	2015-2016
Grade 03	DISTRICT	71.90%	80.40%	76.80%	Grade 03	DISTRICT	73.7%	78.4%	75.0%
	AEA	80.00%	79.40%	78.20%		AEA	77.6%	77.6%	77.4%
	STATE	80.50%	79.60%	79.40%		STATE	77.4%	76.4%	76.8%
Grade 04	DISTRICT	71.70%	73.30%	78.40%	Grade 04	DISTRICT	69.8%	73.3%	76.0%
	AEA	79.60%	80.60%	78.70%		AEA	76.5%	76.9%	77.6%
	STATE	79.70%	79.30%	78.60%		STATE	75.9%	76.0%	75.6%
Grade 05	DISTRICT	87.10%	84.20%	67.20%	Grade 05	DISTRICT	65.7%	82.5%	67.2%
	AEA	79.60%	78.10%	77.30%		AEA	77.5%	78.3%	77.2%
	STATE	77.90%	77.00%	76.40%		STATE	76.7%	77.5%	76.7%
Grade 06	DISTRICT	80.00%	78.50%	86.80%	Grade 06	DISTRICT	71.7%	72.3%	71.7%
	AEA	79.50%	78.60%	76.40%		AEA	74.0%	75.2%	74.5%
	STATE	77.10%	77.50%	76.80%		STATE	74.2%	75.1%	75.0%
Grade 07	DISTRICT	87.70%	76.20%	79.70%	Grade 07	DISTRICT	76.9%	73.0%	75.0%
	AEA	84.10%	82.90%	83.80%		AEA	76.4%	76.4%	77.2%
	STATE	83.60%	83.10%	83.40%		STATE	75.4%	75.9%	75.6%
Grade 08	DISTRICT	81.80%	87.70%	70.80%	Grade 08	DISTRICT	82.1%	84.6%	72.3%
	AEA	76.00%	76.10%	75.80%		AEA	76.1%	75.7%	75.9%
	STATE	75.70%	76.20%	75.30%		STATE	75.1%	75.5%	75.3%
Grade 09	DISTRICT	90.90%	82.50%	86.40%	Grade 09	DISTRICT	94.5%	88.9%	81.8%
	AEA	81.90%	79.70%	79.60%		AEA	85.8%	84.4%	84.5%
	STATE	79.20%	78.20%	77.50%		STATE	83.8%	83.1%	83.0%
Grade 10	DISTRICT	93.00%	94.30%	85.90%	Grade 10	DISTRICT	93.0%	96.2%	89.1%
	AEA	85.40%	84.20%	82.50%		AEA	87.7%	86.9%	86.3%
	STATE	83.00%	82.90%	81.80%		STATE	85.8%	86.0%	85.4%
Grade 11	DISTRICT	94.80%	88.10%	84.60%	Grade 11	DISTRICT	93.1%	84.7%	84.6%
	AEA	86.30%	84.40%	84.30%		AEA	81.9%	80.9%	79.8%
	STATE	83.90%	83.20%	82.20%		STATE	79.4%	79.5%	78.4%

ACT AVERAGES	GRAD YEAR	TEST #	AVG ENGLISH	AVG MATH	AVG READING	AVG SCIENCE
WBCSD	2012	38	20.1	20.9	21.9	22.4
WBCSD	2013	52	21.6	22.1	22.4	23.4
WBCSD	2014	41	20.5	20.8	22.0	21.9
WBCSD	2015	43	23.0	23.5	24.3	23.1
WBCSD	2016	40	22.5	22.4	23.6	23.3

West Branch Facilities Improvements and Bond Information

A comprehensive bond information flyer will be provided to all families in early August.

South Hoover Elementary School

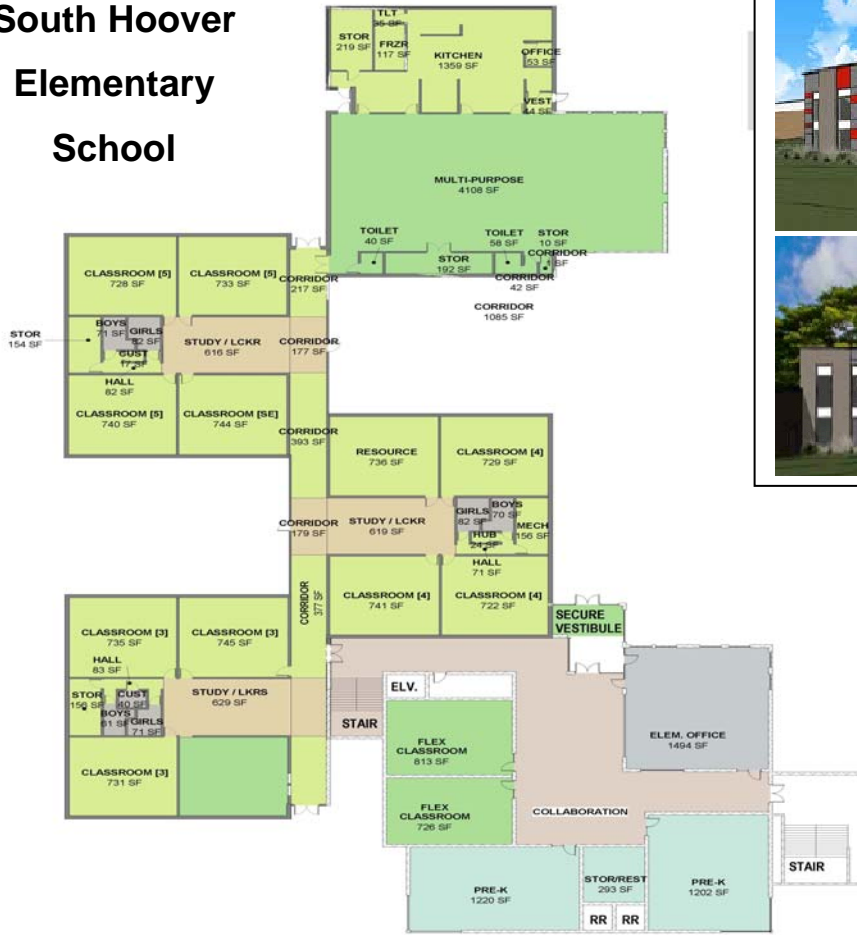

Bond Referendum Vote:
 Tuesday, September 12, 2017
Satellite Voting: Monday, August 21, 2017 - "Back to School Night"

1 SECOND FLOOR PLAN
 SCALE: 1/8" = 1'-0"

North Hoover Elementary School

Lower Level

New two-story addition with new security-enhanced office design, new expanded music room and additional classrooms.

New art classroom

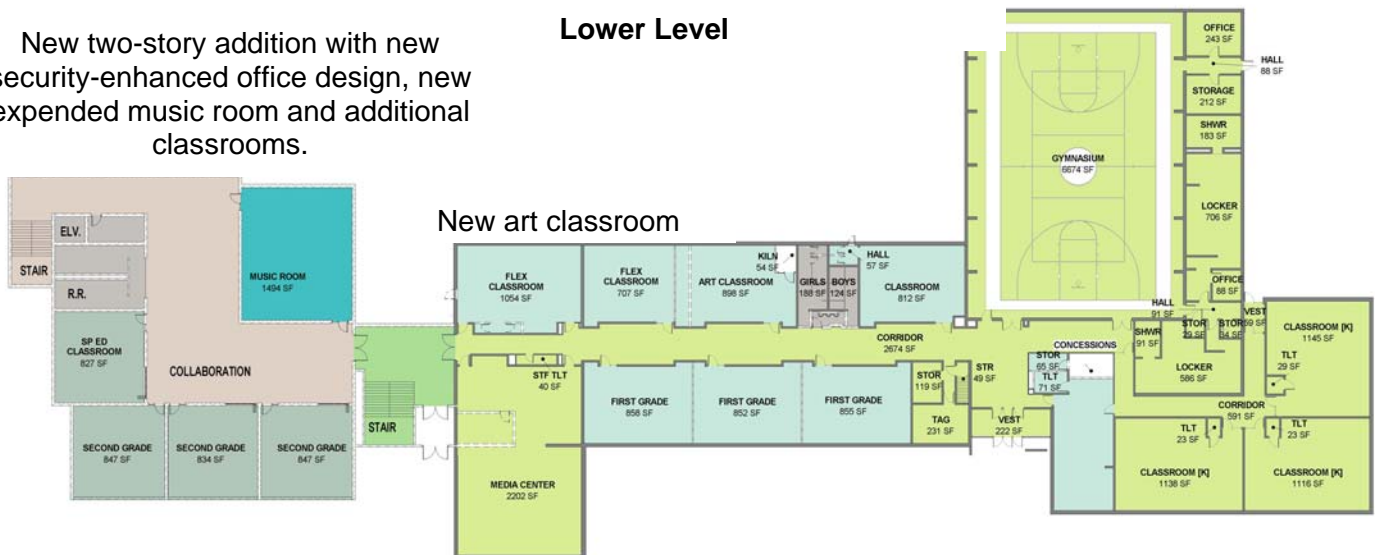

West Branch Facilities Improvements and Bond Information

A comprehensive bond information flyer will be provided to all families in early August

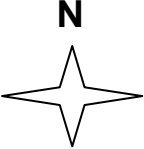

New 700 – 720 seat school / community performing arts auditorium. The stage converts to an additional classroom.

New MS with offices

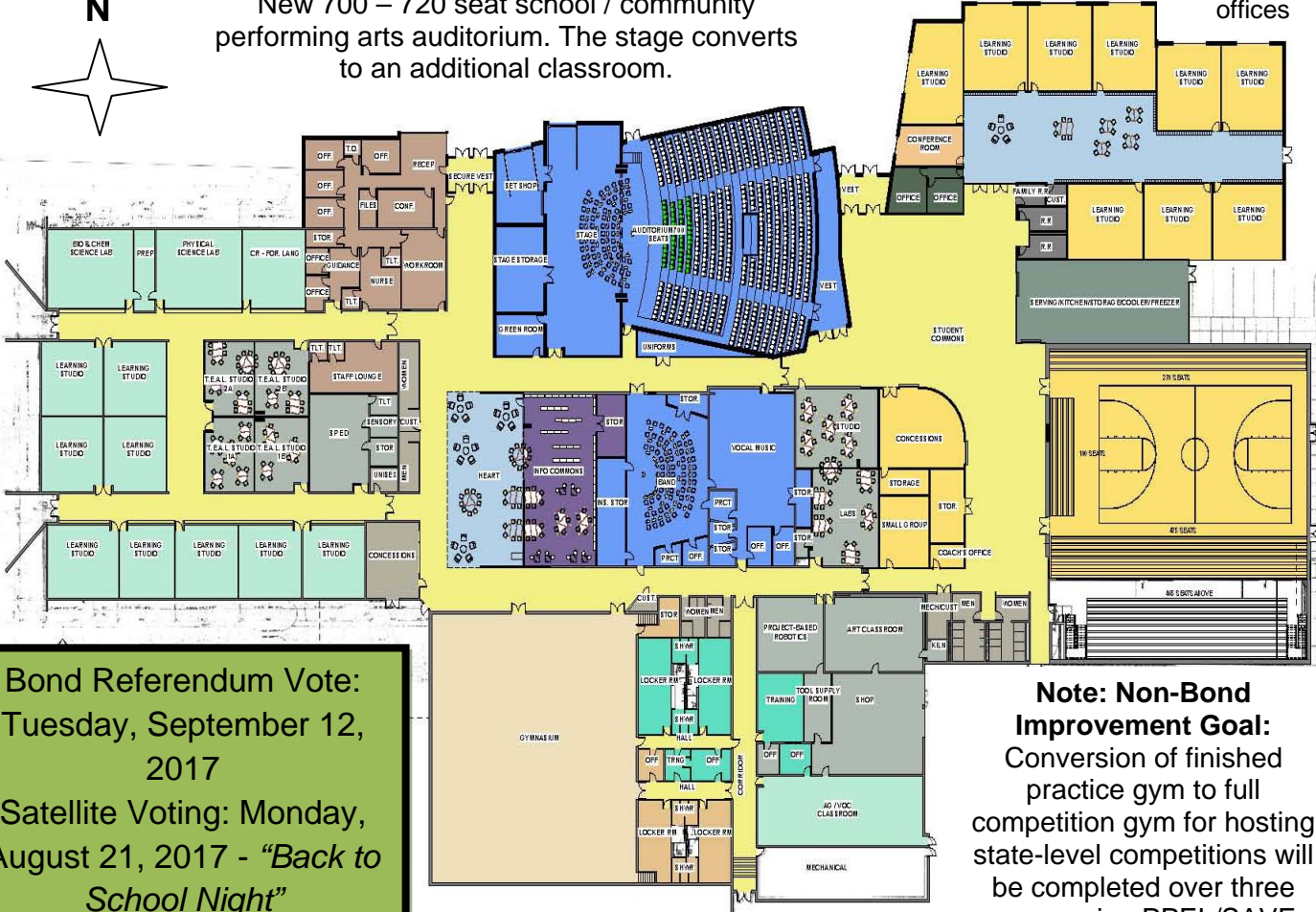

Bond Referendum Vote:
Tuesday, September 12, 2017

Satellite Voting: Monday, August 21, 2017 - *“Back to School Night”*

Note: Non-Bond Improvement Goal:
Conversion of finished practice gym to full competition gym for hosting state-level competitions will be completed over three years using PPEL/SAVE

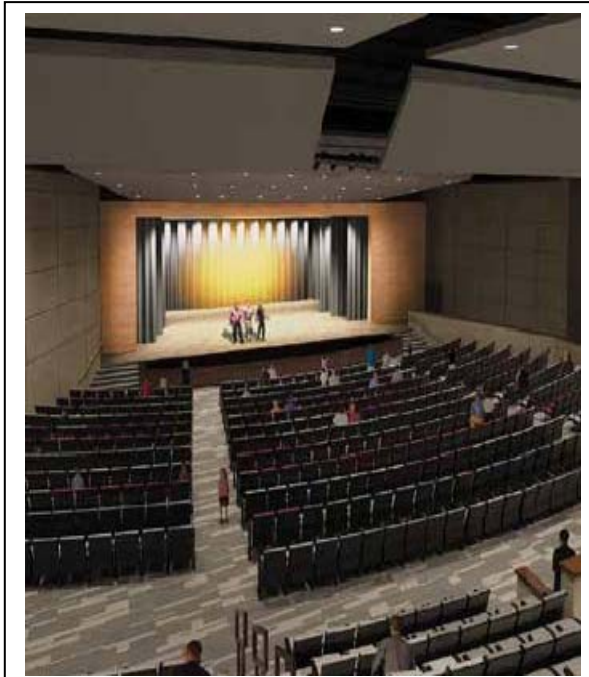

If you have any questions, please don't hesitate to call to speak with me or a board member! Mr. Hatfield – Go Bears!